

LC-XB200/XB100

XGA "Brilliant" Series

EIKI
Projectors & Beyond

New Simple and Easy Portable Projectors for education use.



XGA
1,024 x 768

3,500 lumens

LC-XB200

3,000 lumens

LC-XB100

Outstanding Features

- Brightness 3,500 / 3,000 lumens (XB200 / XB100).
- True XGA resolution. UXGA ~ VGA and MAC compatible.
- Auto setup (Input search, V-keystone correction, PC adjust).
- Inexpensive projector with zoom lens (x 1.6) and network monitoring and control (Wired LAN).
- Big Sound 7-Watt Audio Speaker.
- AC plug out right after Power off.
- Remote control unit with Laser and Mouse control.
- 17 languages (+Thai) (Operation menu).
- Black board (for Green Color) and Color board mode function.
- Lamp replacement on top cabinet.
- Security : PIN code lock, Key lock.
- Closed caption decoding (NTSC).



■ Guidance function helps you

When the signal is not found, Guidance is displayed on a screen and assist how to connect.

Project Video selection window



Project Computer selection window

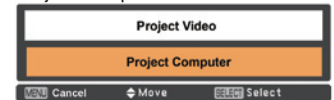

Input signal guidance window

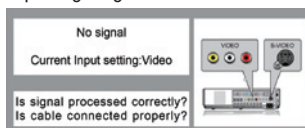

Input signal guidance window

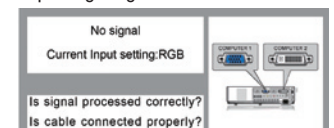

■ Auto input search function helps you

Projector search the input signal and change its setting automatically.

LC-XB200/XB100 XGA "Brilliant" Series

Terminal/Remote control

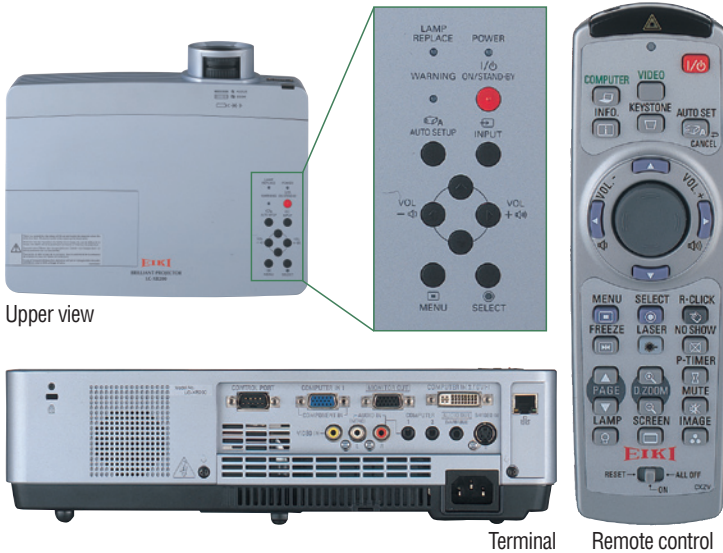

Wireless mouse operation

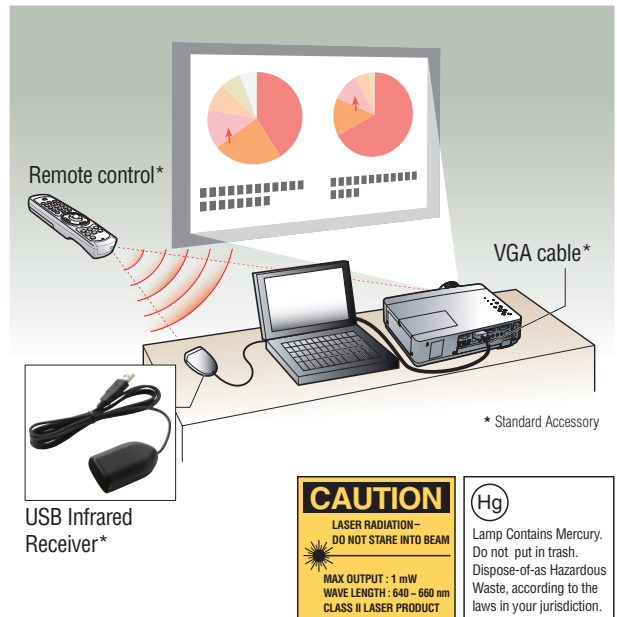

Specifications

Model	LC-XB200	LC-XB100
Screen Brightness	Up to 3,500 lumens	Up to 3,000 lumens
Illumination Uniformity	85 %	
Size of Color Palette	16.7 Million	
Contrast Ratio	500 : 1 (Lamp mode Normal)	
Projection Lamp	225 W UHP	
Estimated Lamp Life	Up to 2,500 Hours of Use	
Imaging System	0.63" Polysilicon active matrix TFT Panels x 3	
Screen Pixels	1,024 x 768 in stripe configuration	
Total Pixels	2,359,296 (<1,024 x 768> x 3)	
Lens Type	Manual Zoom and Focus	
Lens Specs	Speed : f : 1.65 ~ 2.33 ; FL : 0.609 ~ 0.965 in. (15.47 ~ 24.53 mm)	
Lens Ratios	Zoom Max : Min : 1.6 : 1, Throw : Width : 1.18 ~ 1.91 : 1	
Image Diagonal	30 ~ 300 in. (76 ~ 762 cm)	
Image Width	2.0 ~ 20 ft. (0.61 ~ 6.1 m)	
Throw Distance (Wide ~ Tele)	2.3 ~ 23.7 ft. (0.69 ~ 7.23 m)	
Front Elevation / Maximum Pitch	Up to 12° up / Up to 12° up or down	
Anti Keystone	Fixed Image Offset, Ratio (Top : Bottom) 9 : 1	
Vertical Keystone Correction	Digital : Up to 30° up or down	
Scanning Frequency	Auto : H Sync. 15 ~ 100 kHz ; V Sync. 50 ~ 100 Hz	
Dot Clock	140 MHz	
Image Orientation	Normal, Reversed, Inverted	
Local Control / Power Management	Full Function / Auto Shutdown	
Remote Projector Ctrl w/Mouse & Pointer	Wireless (Infra Red) x 1	
Control Port (for RS-232 control)	Dsub 9 Pin x 1	
LAN Port	RJ45 x 1	
Computer Native Resolution	1,024 x 768 (XGA)	
Computer : Compatibility	UXGA (analog only), SXGA+, SXGA, WXGA, XGA, SVGA, VGA & MAC	
Computer : Formats	1,600 x 1,200 or 1,920 x 1,200 through 640 x 480	
Computer : Higher Resolutions	Displayed panned or Smart Compressed	
Computer : Lower Resolution	Displayed normal or Smart Expanded	
Video : Compatibility	NTSC / PAL / SECAM / NTSC 4.43 / PAL-M&N	
Video : HD Compatibility	480i/p, 575i/p, 720p, 1,035i, 1,080i	

Model	LC-XB200	LC-XB100
Video : Formats Supported	Normal 4 : 3 and Wide Screen 16 : 9	
Video : Image Sizing	Video Scaling Technology	
Image Signal Inputs	Computer In 1 / Component In (with optional adapter)	Dsub15 x 1
	Computer In 2 / (Analog & Digital)	DVI-I x 1
Video In	RCA x 1 (Composite) and S-Video x 1 (Y / C)	
Audio : Inputs	Computer 1 & 2 / Component	Stereo : Ministereo x 2
	Composite / S-Video	RCA x 2 (L & R)
Outputs	Monitor Out	Dsub 15 x 1
	Audio : Output	Stereo : Ministereo x 1 (Variable)
Audio : Amplifier	Mono : 7 Watt RMS	
Audio : Built In Speakers	1.4 in. (3.7 cm) x 1	
Fan Noise	as low as 29 dBA	
Cabinet Size (H x W x D)	3.3 x 12.8 x 9.1 in. (83.1 x 326 x 231.6 mm)*	
Weight	6.2 lbs. (2.8 kg)	
Packaged Size (H x W x D)	9.4 x 17.3 x 16.8 in. (238 x 439 x 428 mm)	
Packaged Weight	12.3 lbs. (5.6 kg)	
Power Consumption	2.6 W (Standby Eco) up to 302 Watts	
Heat	8.9 BTU (2.2 KC) (Standby) up to 1,031 BTU (260 KC)	
Power Requirements	100 ~ 240 V AC, 50 / 60 Hz	
Power Cord	10' (3M) Type 3, Detachable	
Electrical Safety Compliance	UL, cUL, IEC	
Electromagnetic Compatibility	FCC Class B, CE Mark	
Security Facilities	Kensington® Security Slot	
Operating Temperature	41 ~ 95 °F (5 ~ 35 °C)	
User Maintenance	Clean Air Filter, Replace Lamp	
Standard Accessories	Owner's Manual (CD-ROM), Quick Reference Guide & Safety Manual, AC Power Cord, Computer cable, Wireless Remote Control & Batteries (AAA x 2), USB IR receiver, Network Software (CD-ROM), Soft Carry Bag, Strap for Lens cap, PIN code label	
Optional Accessories	Replacement Filter, Replacement Lamp, Ceiling Mount, Ceiling Post and Plate	

* Excluding legs and lens

EIKI

Projectors & Beyond

Eiki Industrial Co., Ltd.

4-12 Banzai-cho, Kita-Ku, Osaka, Japan
Tel: (6) 6311-9479 • Fax: (6) 6311-8486
EIKI World Web Site: <http://www.eiki.com>

Talk to your EIKI Dealer... the "pro" in projectors.

Specifications subject to change without notice.
2009 EIKI Industrial Co., Ltd. Printed in Japan.